

# DKN With Preload

DN value	70,000
----------	--------

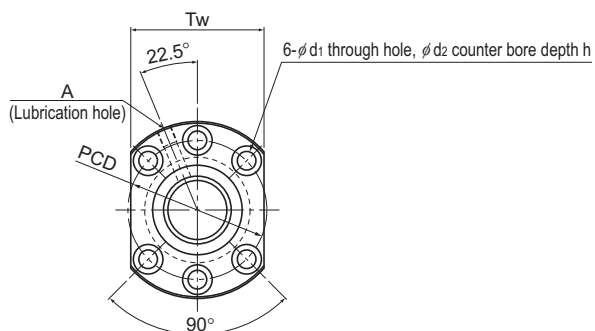

Model No.	Screw shaft outer diameter d	Lead Ph	Ball center-to-center diameter dp	Thread minor diameter dc	No. of loaded circuits Rows X turns	Basic load rating		Rigidity K N/μm	Outer diameter D	Flange diameter D <sub>1</sub>	Overall length L <sub>1</sub>
						Ca kN	C <sub>0a</sub> kN				
DKN 4020-3	40	20	41.75	34.7	3 × 1	29.4	69.3	750	62	104	223
DKN 5020-3	50	20	52.25	43.6	3 × 1	44.2	108.8	930	75	129	243
DKN 6320-3	63	20	65.7	55.9	3 × 1	83.5	229.3	1470	95	159	243

## Positioning Ball Screw

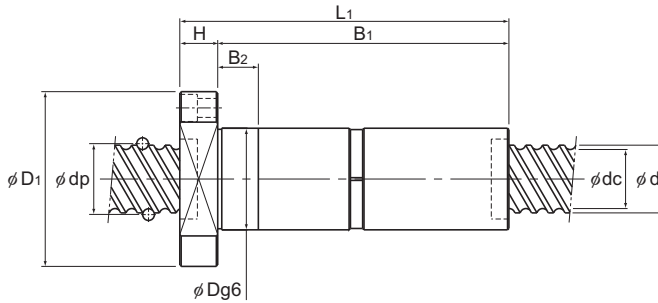

Unit: mm

Nut dimensions							Screw shaft inertial moment/mm kg·m <sup>2</sup> /mm	Nut mass kg	Shaft mass kg/m	Permissible rotational speed min <sup>-1</sup>
H	B <sub>1</sub>	B <sub>2</sub>	PCD	d <sub>1</sub> × d <sub>2</sub> × h	Tw	Lubrication hole A				
18	205	25	82	11 × 17.5 × 11	79	Rc1/8 (PT1/8)	1.97 × 10 <sup>-6</sup>	3.61	9.03	1,670
28	215	30	105	14 × 20 × 13	98		4.82 × 10 <sup>-6</sup>	6.0	13.8	1,330
28	215	30	129	18 × 26 × 17.5	121		1.21 × 10 <sup>-6</sup>	9.5	20.85	1,060

Note: The overall length of the nut will increase when equipping the QZ Lubricator. See **A15-366** for further details.