

BIF-V Small With Preload

DN value	100,000
----------	---------

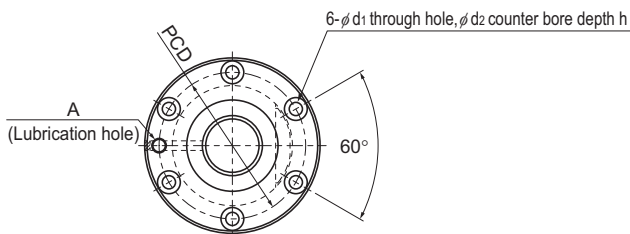

Model No.	Screw shaft outer diameter d	Lead Ph	Ball center-to-center diameter dp	Thread minor diameter dc	No. of loaded circuits Rows × turns	Basic load rating		Rigidity K N/μm
						Ca kN	C _{0a} kN	
BIF 1604V-5	16	4	16.5	13.8	1×2.5	4.3	8.7	298
BIF 1605V-5	16	5	16.75	13.2	1×2.5	7.4	13.9	330
BIF 2004V-5	20	4	20.5	17.8	1×2.5	4.8	10.9	360
BIF 2004V-10	20	4	20.5	17.8	2×2.5	8.6	21.8	692
BIF 2005V-5	20	5	20.75	17.2	1×2.5	8.3	17.5	390
BIF 2005V-10	20	5	20.75	17.2	2×2.5	15.1	35	762
BIF 2010V-5	20	10	20.75	17.2	1×2.5	8.3	17.6	394
BIF 2504V-5	25	4	25.5	22.8	1×2.5	5.2	13.7	426
BIF 2504V-10	25	4	25.5	22.8	2×2.5	9.5	27.4	824
BIF 2505V-5	25	5	25.75	22.2	1×2.5	9.2	21.9	470
BIF 2505V-10	25	5	25.75	22.2	2×2.5	16.7	43.9	910
BIF 2506V-5	25	6	26	21.4	1×2.5	12.4	27.4	482
BIF 2506V-10	25	6	26	21.4	2×2.5	22.6	54.8	934
BIF 2805V-5	28	5	28.75	25.2	1×2.5	9.7	24.6	520
BIF 2805V-10	28	5	28.75	25.2	2×2.5	17.5	49.2	1,000
BIF 2806V-5	28	6	28.75	25.2	1×2.5	9.6	24.6	520
BIF 2806V-10	28	6	28.75	25.2	2×2.5	17.5	49.2	1,000
BIF 3205V-5	32	5	32.75	29.2	1×2.5	10.2	28.1	570
BIF 3205V-10	32	5	32.75	29.2	2×2.5	18.5	56.3	1,110
BIF 3206V-5	32	6	33	28.4	1×2.5	13.9	35.2	600
BIF 3206V-10	32	6	33	28.4	2×2.5	25.2	70.3	1,150

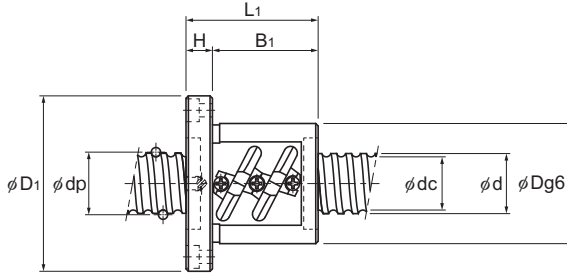

Unit: mm

	Nut dimensions								Screw shaft inertial moment/mm	Nut mass	Shaft mass	Permissible rotational speed
	Outer diameter	Flange diameter	Overall length					Lubrication hole				
	D	D ₁	L ₁	H	B ₁	PCD	d ₁ × d ₂ × h	A				
	36	59	53	11	42	47	5.5 × 9.5 × 5.5	M6	5.05 × 10 ⁻⁸	0.42	1.42	5,000
	40	60	56	10	46	50	4.5 × 8 × 4.5	M6	5.05 × 10 ⁻⁸	0.56	1.37	5,000
	40	63	49	11	38	51	5.5 × 9.5 × 5.5	M6	1.23 × 10 ⁻⁷	0.43	2.22	4,870
	40	63	73	11	62	51	5.5 × 9.5 × 5.5	M6	1.23 × 10 ⁻⁷	0.55	2.22	4,870
	44	67	56	11	45	55	5.5 × 9.5 × 5.5	M6	1.23 × 10 ⁻⁷	0.57	2.19	4,810
	44	67	86	11	75	55	5.5 × 9.5 × 5.5	M6	1.23 × 10 ⁻⁷	0.79	2.19	4,810
	46	74	90	15	75	59	5.5 × 9.5 × 5.5	M6	1.23 × 10 ⁻⁷	1.06	2.46	4,810
	46	69	48	11	37	57	5.5 × 9.5 × 5.5	M6	3.01 × 10 ⁻⁷	0.55	3.6	3,920
	46	69	72	11	61	57	5.5 × 9.5 × 5.5	M6	3.01 × 10 ⁻⁷	0.66	3.6	3,920
	50	73	55	11	44	61	5.5 × 9.5 × 5.5	M6	3.01 × 10 ⁻⁷	0.75	3.52	3,880
	50	73	85	11	74	61	5.5 × 9.5 × 5.5	M6	3.01 × 10 ⁻⁷	0.96	3.52	3,880
	53	76	62	11	51	64	5.5 × 9.5 × 5.5	M6	3.01 × 10 ⁻⁷	0.9	3.43	3,840
	53	76	98	11	87	64	5.5 × 9.5 × 5.5	M6	3.01 × 10 ⁻⁷	1.22	3.43	3,840
	55	85	59	12	47	69	6.6 × 11 × 6.5	M6	4.74 × 10 ⁻⁷	0.98	4.35	3,470
	55	85	89	12	77	69	6.6 × 11 × 6.5	M6	4.74 × 10 ⁻⁷	1.34	4.35	3,470
	55	85	68	12	56	69	6.6 × 11 × 6.5	M6	4.74 × 10 ⁻⁷	1.09	4.52	3,470
	55	85	104	12	92	69	6.6 × 11 × 6.5	M6	4.74 × 10 ⁻⁷	1.52	4.52	3,470
	58	85	56	12	44	71	6.6 × 11 × 6.5	M6	8.08 × 10 ⁻⁷	0.94	5.89	3,050
	58	85	86	12	74	71	6.6 × 11 × 6.5	M6	8.08 × 10 ⁻⁷	1.31	5.89	3,050
	62	89	63	12	51	75	6.6 × 11 × 6.5	M6	8.08 × 10 ⁻⁷	1.21	5.88	3,030
	62	89	99	12	87	75	6.6 × 11 × 6.5	M6	8.08 × 10 ⁻⁷	1.75	5.88	3,030

Note: The overall length of the nut will increase when equipping the QZ Lubricator. See **A15-366** for further details.

BIF-V Medium With Preload

DN value	130,000
----------	---------

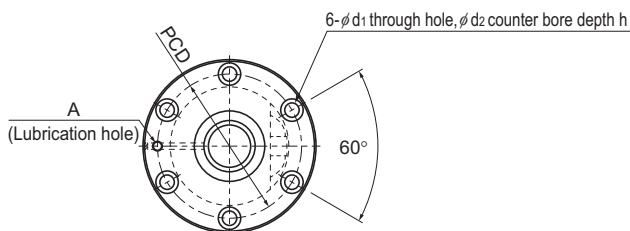

Model No.	Screw shaft outer diameter d	Lead Ph	Ball center-to-center diameter dp	Thread minor diameter dc	No. of loaded circuits Rows × turns	Basic load rating		Rigidity K N/μm
						Ca kN	C _{0a} kN	
BIF 2508V-5	25	8	26.25	20.5	1×2.5	15.8	32.9	500
BIF 2508V-7	25	8	26.25	20.5	1×3.5	21.1	46	688
BIF 2508V-10	25	8	26.25	20.5	2×2.5	28.7	65.7	968
BIF 2510V-5	25	10	26.25	21.5	1×2.5	15.8	32.9	500
BIF 2810V-3	28	10	29.75	22.4	1×1.5	15.6	29.4	350
BIF 3210V-5	32	10	33.75	26.4	1×2.5	26	56.2	640
BIF 3210V-7	32	10	33.75	26.4	1×3.5	34.8	78.6	874
BIF 3210V-10	32	10	33.75	26.4	2×2.5	47.3	112.3	1,128
BIF 3212V-5	32	12	34	26.1	1×2.5	30.2	63.2	644
BIF 3212V-7	32	12	34	26.1	1×3.5	40.4	88.5	888
BIF 3216V-5	32	16	33.75	26.4	1×2.5	25.9	56.5	636
BIF 3610V-5	36	10	37.75	30.5	1×2.5	27.6	63.3	696
BIF 3610V-7	36	10	37.75	30.5	1×3.5	36.9	88.6	700
BIF 3610V-10	36	10	37.75	30.5	2×2.5	50.1	126.5	1,350
BIF 3612V-5	36	12	38	30.1	1×2.5	32.2	71.2	708
BIF 3612V-7	36	12	38	30.1	1×3.5	43	99.6	976
BIF 3612V-10	36	12	38	30.1	2×2.5	58.4	142.3	1,372
BIF 3616V-5	36	16	38	30.1	1×2.5	32.1	71.5	710
BIF 3620V-3	36	20	37.75	30.5	1×1.5	17.7	38.4	430
BIF 4010V-5	40	10	41.75	34.4	1×2.5	29	70.4	750
BIF 4010V-7	40	10	41.75	34.4	1×3.5	38.8	98.5	1,044
BIF 4010V-10	40	10	41.75	34.4	2×2.5	52.7	140.7	1,470
BIF 4012V-5	40	12	42	34.1	1×2.5	33.9	79.2	770
BIF 4012V-7	40	12	42	34.1	1×3.5	45.3	110.8	1,062
BIF 4012V-10	40	12	42	34.1	2×2.5	61.6	158.3	1,490
BIF 4016V-5	40	16	42	34.1	1×2.5	33.9	79.4	772
BIF 4020V-5	40	20	41.75	34.4	1×2.5	28.9	71	760

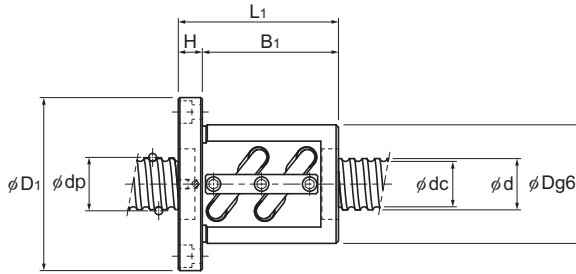

Unit: mm

	Nut dimensions								Screw shaft inertial moment/mm ²	Nut mass	Shaft mass	Permissible rotational speed
	Outer diameter	Flange diameter	Overall length					Lubrication hole				
	D	D ₁	L ₁	H	B ₁	PCD	d ₁ × d ₂ × h	A				
	58	85	82	15	67	71	6.6 × 11 × 6.5	M6	3.01 × 10 ⁻⁷	1.52	3.51	4,950
	58	85	98	15	83	71	6.6 × 11 × 6.5	M6	3.01 × 10 ⁻⁷	1.5	3.51	4,950
	58	85	130	15	115	71	6.6 × 11 × 6.5	M6	3.01 × 10 ⁻⁷	1.93	3.51	4,950
	58	85	100	18	82	71	6.6 × 11 × 6.5	M6	3.01 × 10 ⁻⁷	1.31	3.5	4,950
	65	106	88	18	70	85	11 × 17.5 × 11	M6	4.74 × 10 ⁻⁷	2.33	4.15	4,360
	74	108	100	15	85	90	9 × 14 × 8.5	M6	8.08 × 10 ⁻⁷	2.92	5.53	3,850
	74	108	120	15	105	90	9 × 14 × 8.5	M6	8.08 × 10 ⁻⁷	3.1	5.53	3,850
	74	108	160	15	145	90	9 × 14 × 8.5	M6	8.08 × 10 ⁻⁷	4.27	5.53	3,850
	76	121	117	18	99	98	11 × 17.5 × 11	M6	8.08 × 10 ⁻⁷	3.7	5.7	3,820
	76	121	146	18	128	98	11 × 17.5 × 11	M6	8.08 × 10 ⁻⁷	3.7	5.7	3,820
	74	108	139	18	121	90	9 × 14 × 8.5	M6	8.08 × 10 ⁻⁷	3.81	5.82	3,850
	75	120	111	18	93	98	11 × 17.5 × 11	M6	1.29 × 10 ⁻⁶	3.45	7.1	3,440
	75	120	123	18	105	98	11 × 17.5 × 11	M6	1.29 × 10 ⁻⁶	3.82	7.1	3,440
	75	120	171	18	153	98	11 × 17.5 × 11	M6	1.29 × 10 ⁻⁶	4.84	7.1	3,440
	78	123	123	18	105	100	11 × 17.5 × 11	M6	1.29 × 10 ⁻⁶	4.69	7.99	3,420
	78	123	140	18	122	100	11 × 17.5 × 11	M6	1.29 × 10 ⁻⁶	4.34	7.99	3,420
	78	123	195	18	177	100	11 × 17.5 × 11	M6	1.29 × 10 ⁻⁶	5.67	7.99	3,420
	78	123	140	18	122	100	11 × 17.5 × 11	M6	1.29 × 10 ⁻⁶	4.31	7.99	3,420
	75	114	122	18	104	93	11 × 17.5 × 11	M6	1.29 × 10 ⁻⁶	3.4	7.54	3,440
	82	124	103	18	85	102	11 × 17.5 × 11	M6	1.97 × 10 ⁻⁶	3.61	8.87	3,110
	82	124	123	18	105	102	11 × 17.5 × 11	M6	1.97 × 10 ⁻⁶	3.97	8.87	3,110
	82	124	163	18	145	102	11 × 17.5 × 11	M6	1.97 × 10 ⁻⁶	5.33	8.87	3,110
	84	126	119	18	101	104	11 × 17.5 × 11	M6	1.97 × 10 ⁻⁶	4.36	8.83	3,090
	84	126	143	18	125	104	11 × 17.5 × 11	M6	1.97 × 10 ⁻⁶	4.92	8.83	3,090
	84	126	191	18	173	104	11 × 17.5 × 11	M6	1.97 × 10 ⁻⁶	6.47	8.83	3,090
	84	126	144	18	126	104	11 × 17.5 × 11	M6	1.97 × 10 ⁻⁶	4.9	9.09	3,090
	82	126	162	18	144	104	11 × 17.5 × 11	M6	1.97 × 10 ⁻⁶	5.17	9.37	3,110

Note: The overall length of the nut will increase when equipping the QZ Lubricator. See **A15-366** for further details.

BIF-V Medium With Preload

DN value	130,000
----------	---------

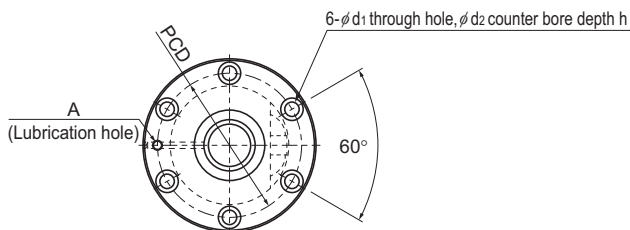

Model No.	Screw shaft outer diameter d	Lead Ph	Ball center-to-center diameter dp	Thread minor diameter dc	No. of loaded circuits Rows × turns	Basic load rating		Rigidity K N/μm
						Ca kN	C _{0a} kN	
BIF 4510V-5	45	10	46.75	39.5	1 × 2.5	30.6	79.3	830
BIF 4510V-10	45	10	46.75	39.5	2 × 2.5	55.6	158.5	1,610
BIF 4512V-5	45	12	47	39.2	1 × 2.5	35.9	89.2	846
BIF 4512V-10	45	12	47	39.2	2 × 2.5	65.2	178.3	1,638
BIF 4516V-5	45	16	47	39.2	1 × 2.5	35.8	89.4	846
BIF 4520V-5	45	20	47	39.2	1 × 2.5	35.8	89.7	848
BIF 5010V-5	50	10	51.75	44.4	1 × 2.5	32.1	88.1	900
BIF 5010V-7	50	10	51.75	44.4	1 × 3.5	42.9	123.4	1,244
BIF 5010V-10	50	10	51.75	44.4	2 × 2.5	58.2	176.3	1,750
BIF 5012V-5	50	12	52.25	43.3	1 × 2.5	43.4	110.1	934
BIF 5012V-7	50	12	52.25	43.3	1 × 3.5	58	154.1	1,286
BIF 5012V-10	50	12	52.25	43.3	2 × 2.5	78.8	220.2	1,808
BIF 5016V-5	50	16	52.7	42.9	1 × 2.5	72.6	183.1	1,220
BIF 5016V-10	50	16	52.7	42.9	2 × 2.5	131.8	366.2	2,364
BIF 5020V-5	50	20	52.7	42.9	1 × 2.5	72.5	183.6	1,222

Positioning Ball Screw

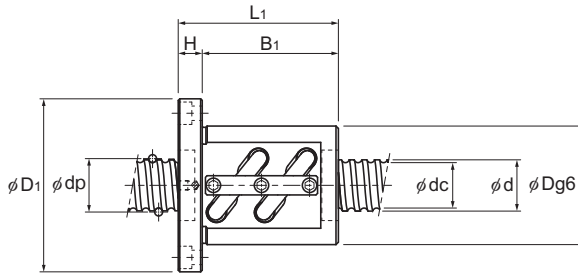

Unit: mm

	Nut dimensions							Screw shaft inertial moment/mm ³	Nut mass	Shaft mass	Permissible rotational speed	
	Outer diameter	Flange diameter	Overall length	H	B ₁	PCD	d ₁ × d ₂ × h					Lubrication hole
	D	D ₁	L ₁	H	B ₁	PCD	d ₁ × d ₂ × h	A	kg·m ² /mm	kg	kg/m	min ⁻¹
	88	132	111	18	93	110	11 × 17.5 × 11	Rc1/8 (PT1/8)	3.16 × 10 ⁻⁶	4.29	12.48	2,780
	88	132	171	18	153	110	11 × 17.5 × 11		3.16 × 10 ⁻⁶	5.97	12.48	2,780
	90	130	119	18	101	110	11 × 17.5 × 11		3.16 × 10 ⁻⁶	4.6	11.32	2,760
	90	130	191	18	173	110	11 × 17.5 × 11		3.16 × 10 ⁻⁶	6.67	11.32	2,760
	90	130	140	18	122	110	11 × 17.5 × 11		3.16 × 10 ⁻⁶	5.3	11.61	2,760
	90	130	162	18	144	110	11 × 17.5 × 11		3.16 × 10 ⁻⁶	5.96	11.1	2,760
	93	135	103	18	85	113	11 × 17.5 × 11		4.82 × 10 ⁻⁶	4.28	14.16	2,510
	93	135	123	18	105	113	11 × 17.5 × 11		4.82 × 10 ⁻⁶	4.94	14.16	2,510
	93	135	163	18	145	113	11 × 17.5 × 11		4.82 × 10 ⁻⁶	6.26	14.16	2,510
	100	146	123	22	101	122	14 × 20 × 13		4.82 × 10 ⁻⁶	6.12	13.82	2,480
	100	146	147	22	125	122	14 × 20 × 13		4.82 × 10 ⁻⁶	7.06	13.82	2,480
	100	146	195	22	173	122	14 × 20 × 13		4.82 × 10 ⁻⁶	8.91	13.82	2,480
	105	152	164	25	139	128	14 × 20 × 13		4.82 × 10 ⁻⁶	8.82	13.71	2,460
	105	152	260	25	235	128	14 × 20 × 13		4.82 × 10 ⁻⁶	12.3	13.71	2,460
	105	152	201	28	173	128	14 × 20 × 13		4.82 × 10 ⁻⁶	10.63	14.05	2,460

Note: The overall length of the nut will increase when equipping the QZ Lubricator. See **A15-366** for further details.

BIF (Unfinished Shaft Ends) With Preload

DN value	70,000
----------	--------

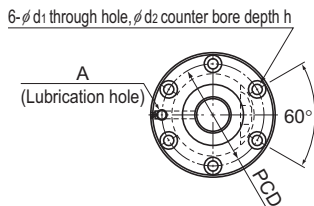

Model No.	Ball screw specifications							Nut			
	Screw shaft outer diameter d	Lead Ph	Ball center-to-center diameter dp	Thread minor diameter dc	No. of loaded circuits Rows X turns	Basic load rating		Outer diameter D	Flange diameter D _f	Overall length L ₁	Nut H
						Ca kN	C _{0a} kN				
BIF 1605-5	16	5	16.75	13.2	1×2.5	7.4	13.9	40	60	56	10
BIF 1810-3	18	10	18.8	15.5	1×1.5	5.1	9.6	42	65	75	12
BIF 2005-5	20	5	20.75	17.2	1×2.5	8.3	17.4	44	67	56	11
BIF 2505-5	25	5	25.75	22.2	1×2.5	9.2	22	50	73	55	11

Model number coding

BIF2005-5 RR G0 +610L C5 A

Model No.

Symbol for clearance
in the axial direction²

Accuracy symbol³

Unfinished shaft ends code (A or B)

Seal symbol¹

Overall screw shaft
length (in mm)

¹ See **A15-356**. ² See **A15-19**. ³ See **A15-12**.

Positioning Ball Screw

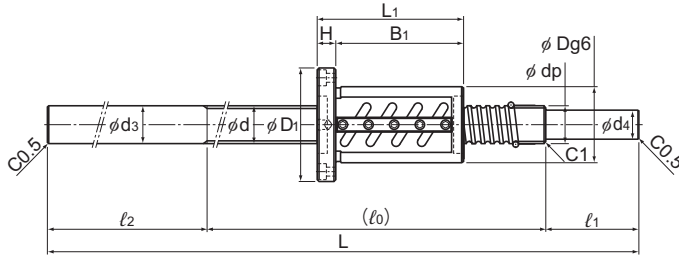

Unit: mm

Dimensions						Screw shaft dimensions							Nut mass kg	Shaft mass kg/m	Permissible rotational speed min ⁻¹
B ₁	PCD	d ₁	d ₂	h	Lubrication hole A	Standard stock symbol	Overall length L	l ₀	l ₁	l ₂	d ₃	d ₄			
46	50	4.5	8	4.5	M6	A	410	200	50	160	16	12.8	0.56	0.92	4,170
							510	300							
							610	400							
							710	500							
63	53	5.5	9.5	5.5	M6	A	410	200	50	160	18	15.3	0.75	1.62	3,720
							510	300							
							610	400							
							710	500							
45	55	5.5	9.5	5.5	M6	A	410	200	50	160	20	15.3	0.57	1.65	3,370
							510	300							
							610	400							
							710	500							
						B	810	600	16.8						
							1,010	800							
							610	300		50	260	20	16.8		
							710	400							
44	61	5.5	9.5	5.5	M6	A	520	300	60	160	25	20.3	0.75	2.84	2,710
							620	400							
							720	500							
							820	600							
						B	1,020	800	21.8						
							1,220	1,000							
							1,420	1,200							
							720	400		60	260	25	21.8		
820	500														

Ball Screw

BIF (Unfinished Shaft Ends) With Preload

DN value	70,000
----------	--------

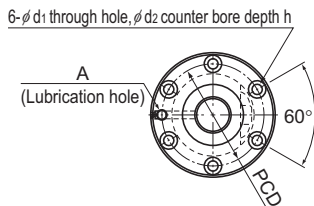

Model No.	Ball screw specifications							Nut			
	Screw shaft outer diameter d	Lead Ph	Ball center-to-center diameter dp	Thread minor diameter dc	No. of loaded circuits Rows X turns	Basic load rating		Outer diameter D	Flange diameter D _f	Overall length L ₁	Nut H
						Ca kN	C:a kN				
BIF 2510A-5	25	10	26.3	21.4	1×2.5	15.8	33	58	85	100	18
BIF 2806-5 BIF 2806-10	28	6	28.75	25.2	1×2.5 2×2.5	9.6 17.5	24.6 49.4	55	85	68 104	12
BIF 3205-5 BIF 3205-10	32	5	32.75	29.2	1×2.5 2×2.5	10.2 18.5	28.1 56.4	58	85	56 86	12

Model number coding

BIF2806-10 RR G0 +1020L C5 A

Model No.

Symbol for clearance
in the axial direction ²

Accuracy symbol ³

Unfinished shaft ends code (A or B)

Seal symbol¹

Overall screw shaft
length (in mm)

¹ See **A15-356**. ² See **A15-19**. ³ See **A15-12**.

Positioning Ball Screw

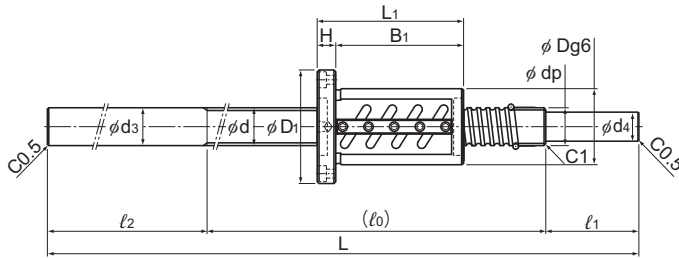

Unit: mm

Dimensions						Screw shaft dimensions								Nut mass kg	Shaft mass kg/m	Permissible rotational speed min ⁻¹
B ₁	PCD	d ₁	d ₂	h	Lubrication hole A	Standard stock symbol	Overall length L	l ₀	l ₁	l ₂	d ₃	d ₄				
82	71	6.6	11	6.5	M6	A	620	400	60	160	25	20.3	1.87	2.68	2,660	
							820	600								
							1,020	800								
							1,220	1,000								
							1,420	1,200								
56 92	69	6.6	11	6.5	M6	A	520	300	60	160	28	20.3	1.57	3.89	2,430	
							620	400								
							720	500								
							920	700								
							1,020	800								
							1,220	1,000								
							1,420	1,200								
						B	720	400	70	250	28	24.8				
							920	500		350						
							1,100	700		330						
44 74	71	6.6	11	6.5	M6	A	730	500	70	160	32	25.3	0.87 1.32	5.03	2,130	
							930	700								
							1,230	1,000								
							1,430	1,200								
							1,630	1,400								
							1,830	1,600				27.8				

Ball Screw

BIF (Unfinished Shaft Ends) With Preload

DN value	70,000
----------	--------

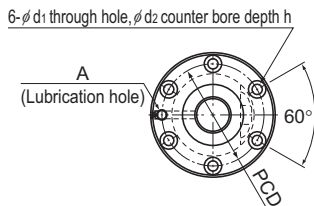

Model No.	Ball screw specifications							Nut			
	Screw shaft outer diameter d	Lead Ph	Ball center-to-center diameter dp	Thread minor diameter dc	No. of loaded circuits Rows X turns	Basic load rating		Outer diameter D	Flange diameter D _f	Overall length L ₁	Nut H
						Ca kN	C _{0a} kN				
BIF 3206-5 BIF 3206-10	32	6	33	28.4	1×2.5 2×2.5	13.9 25.2	35.2 70.4	62	89	63 99	12
BIF 3210A-5	32	10	33.75	26.4	1×2.5	26.1	56.2	74	108	100	15
BIF 3610-5 BIF 3610-10	36	10	37.75	30.5	1×2.5 2×2.5	27.6 50.1	63.3 126.4	75	120	111 171	18

Model number coding

BIF3206-10 RR G0 +1100L C5 B

Model No.

Symbol for clearance
in the axial direction²

Accuracy symbol³

Unfinished shaft ends code (A or B)

Seal symbol¹ Overall screw shaft
length (in mm)

¹ See **A15-356**. ² See **A15-19**. ³ See **A15-12**.

Positioning Ball Screw

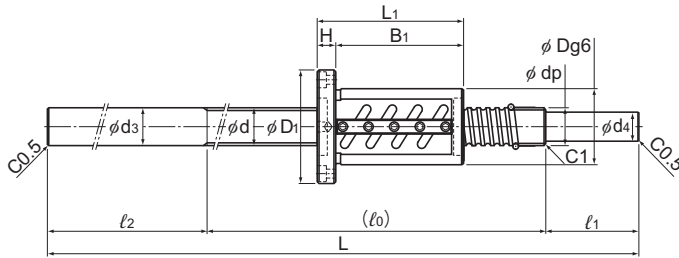

Unit: mm

Dimensions						Screw shaft dimensions								Nut mass kg	Shaft mass kg/m	Permissible rotational speed min ⁻¹
B ₁	PCD	d ₁	d ₂	h	Lubrication hole A	Standard stock symbol	Overall length L	l ₀	l ₁	l ₂	d ₃	d ₄				
51 87	75	6.6	11	6.5	M6	A	730	500	70	160	32	25.3	1.2 1.76	4.63	2,120	
							930	700								
							1,230	1,000								
							1,430	1,200								
						1,630	1,400									
						1,830	1,600									
						B	930	500	70	360	32	27.8				
							1,100	700		330						
1,430	1,000	360														
85	90	9	14	8.5	M6	A	730	500	70	160	32	25.3	2.8	3.66	2,070	
							930	700								
							1,430	1,200								
							1,830	1,600								
93 153	98	11	17.5	11	M6	A	730	500	70	160	36	30.3	3.4 4.8	5.03	1,850	
							930	700								
							1,430	1,200								
							1,830	1,600								
						B	930	500	100	330						
							1,100	700		300						
							1,830	1,200		530						

Ball Screw

BIF (Unfinished Shaft Ends) With Preload

DN value	70,000
----------	--------

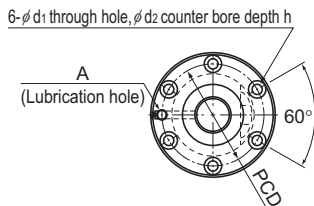

Model No.	Ball screw specifications							Nut			
	Screw shaft outer diameter d	Lead Ph	Ball center-to-center diameter dp	Thread minor diameter dc	No. of loaded circuits Rows X turns	Basic load rating		Outer diameter D	Flange diameter D _f	Overall length L ₁	Nut H
						Ca kN	C _{0a} kN				
BIF 4010-5 BIF 4010-10	40	10	41.75	34.4	1×2.5 2×2.5	29 52.7	70.4 141.1	82	124	103 163	18
BIF 4012-5 BIF 4012-10	40	12	42	34.1	1×2.5 2×2.5	33.9 61.6	79.2 158.8	84	126	119 191	18
BIF 5010-5 BIF 5010-10	50	10	51.75	44.4	1×2.5 2×2.5	32 58.2	88.2 176.4	93	135	103 163	18

Model number coding

BIF4012-10 RR G0 +1230L C5 A

Model No.

Symbol for clearance
in the axial direction²

Accuracy symbol³

Unfinished shaft ends code (A or B)

Seal symbol¹

Overall screw shaft
length (in mm)

¹ See **A15-356**. ² See **A15-19**. ³ See **A15-12**.

Positioning Ball Screw

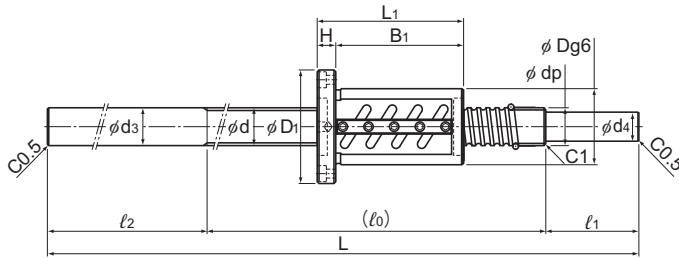

Unit: mm

Dimensions						Screw shaft dimensions								Nut mass kg	Shaft mass kg/m	Permissible rotational speed min ⁻¹
B ₁	PCD	d ₁	d ₂	h	Lubrication hole A	Standard stock symbol	Overall length L	l ₀	l ₁	l ₂	d ₃	d ₄				
85 145	102	11	17.5	11	M6	A	1,230	1,000	70	160	40	30.3	3.58 5.18	6.59	1,670	
							1,730	1,500								
							2,030	1,800								
							2,230	2,000								
101 173	104	11	17.5	11	M6	A	1,230	1,000	70	160	40	30.3	4.2 6.24	6.39	1,660	
							1,730	1,500								
							2,030	1,800								
							2,230	2,000								
						B	1,730	1,200	100	430	40	33.8				
							2,030	1,200		730						
85 145	113	11	17.5	11	Rc1/8 (PT1/8)	A	1,300	1,000	100	200	50	40.3	4.4 6.35	11.36	1,350	
							1,800	1,500								
							2,300	2,000								
							2,800	2,500								

Ball Screw