

DIK With Preload

DN value	70,000
----------	--------

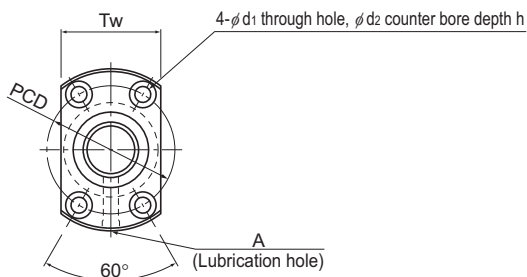

Model No.	Screw shaft outer diameter d	Lead Ph	Ball center-to-center diameter dp	Thread minor diameter dc	No. of loaded circuits Rows × turns	Basic load rating		Rigidity K N/μm
						Ca kN	C _{0a} kN	
DIK 1404-4	14	4	14.5	11.8	2×1	3	5.1	190
DIK 1404-6	14	4	14.5	11.8	3×1	4.2	7.7	280
DIK 1605-6	16	5	16.75	13.2	3×1	7.4	13	310
DIK 2004-6	20	4	20.5	17.8	3×1	5.2	11.6	380
DIK 2004-8	20	4	20.5	17.8	4×1	6.6	15.5	510
DIK 2005-6	20	5	20.75	17.2	3×1	8.5	17.3	310
DIK 2006-6	20	6	21	16.4	3×1	11.4	21.5	410
DIK 2008-4	20	8	21	16.4	2×1	8.1	14.4	280
DIK 2504-6	25	4	25.5	22.8	3×1	5.7	15	470
DIK 2504-8	25	4	25.5	22.8	4×1	7.4	19.9	620
DIK 2505-6	25	5	25.75	22.2	3×1	9.7	22.6	490
DIK 2506-4	25	6	26	21.4	2×1	9.1	18	330
DIK 2506-6	25	6	26	21.4	3×1	12.8	27	490
DIK 2508-4	25	8	26	21.4	2×1	9.2	18.8	340
DIK 2508-6	25	8	26	21.4	3×1	13.1	28.1	500
DIK 2510-4	25	10	26	21.6	2×1	9	18	330

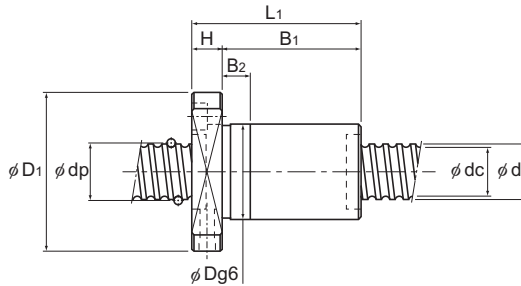

Unit: mm

	Nut dimensions										Screw shaft inertial moment/mm ³	Nut mass	Shaft mass	Permissible rotational speed
	Outer diameter	Flange diameter	Overall length	H	B ₁	B ₂	PCD	d ₁ ×d ₂ ×h	Tw	Lubrication hole				
	D	D ₁	L ₁											
	26	45	48	10	38	10	35	4.5×8×4.5	29	M6	2.96×10 ⁻⁸	0.2	1	4,820
	26	45	60	10	50	10	35	4.5×8×4.5	29	M6	2.96×10 ⁻⁸	0.23	1	4,820
	30	49	60	10	50	10	39	4.5×8×4.5	31	M6	5.05×10 ⁻⁸	0.3	1.25	4,170
	32	56	62	11	51	15	44	5.5×9.5×5.5	35	M6	1.23×10 ⁻⁷	0.34	2.18	3,410
	32	56	70	11	59	15	44	5.5×9.5×5.5	35	M6	1.23×10 ⁻⁷	0.37	2.18	3,410
	34	58	61	11	50	10	46	5.5×9.5×5.5	36	M6	1.23×10 ⁻⁷	0.38	2.06	3,370
	35	58	76	11	65	15	46	5.5×9.5×5.5	36	M6	1.23×10 ⁻⁷	0.48	1.93	3,330
	35	58	69	11	58	15	46	5.5×9.5×5.5	36	M6	1.23×10 ⁻⁷	0.45	2.06	3,330
	38	63	63	11	52	15	51	5.5×9.5×5.5	39	M6	3.01×10 ⁻⁷	0.43	3.5	2,740
	38	63	71	11	60	15	51	5.5×9.5×5.5	39	M6	3.01×10 ⁻⁷	0.47	3.5	2,740
	40	63	61	11	50	10	51	5.5×9.5×5.5	41	M6	3.01×10 ⁻⁷	0.47	3.35	2,710
	40	63	60	11	49	10	51	5.5×9.5×5.5	41	M6	3.01×10 ⁻⁷	0.46	3.19	2,690
	40	63	72	11	61	15	51	5.5×9.5×5.5	41	M6	3.01×10 ⁻⁷	0.54	3.19	2,690
	40	63	71	12	59	15	51	5.5×9.5×5.5	41	M6	3.01×10 ⁻⁷	0.54	3.35	2,690
	40	63	94	12	82	25	51	5.5×9.5×5.5	41	M6	3.01×10 ⁻⁷	0.68	3.35	2,690
	40	63	85	15	70	20	51	5.5×9.5×5.5	41	M6	3.01×10 ⁻⁷	0.65	3.45	2,690

Note: The overall length of the nut will increase when equipping the QZ Lubricator. See **A15-366** for further details.

DIK With Preload

DN value	70,000
----------	--------

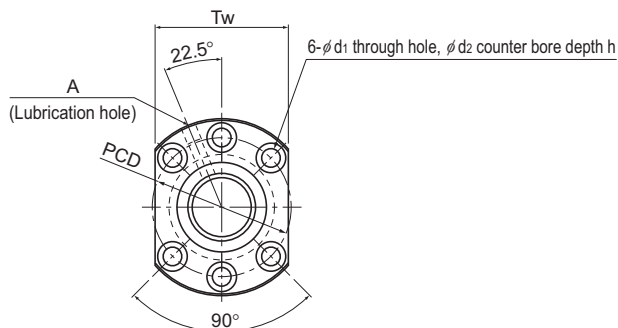

Model No.	Screw shaft outer diameter d	Lead Ph	Ball center-to-center diameter dp	Thread minor diameter dc	No. of loaded circuits Rows × turns	Basic load rating		Rigidity K N/μm
						Ca kN	C _{0a} kN	
DIK 2805-6	28	5	28.75	25.2	3 × 1	10.5	26.4	560
DIK 2805-8	28	5	28.75	25.2	4 × 1	13.4	35.2	730
DIK 2806-6	28	6	29	24.4	3 × 1	14	32	530
DIK 2810-4	28	10	29.25	23.6	2 × 1	12.3	25	380
DIK 3204-6	32	4	32.5	30.1	3 × 1	6.4	19.6	580
DIK 3204-8	32	4	32.5	30.1	4 × 1	8.2	26.1	760
DIK 3204-10	32	4	32.5	30.1	5 × 1	10	32.7	940
DIK 3205-6	32	5	32.75	29.2	3 × 1	11.1	30.2	620
DIK 3205-8	32	5	32.75	29.2	4 × 1	14.2	40.3	810
DIK 3206-6	32	6	33	28.4	3 × 1	14.9	37.1	630
DIK 3206-8	32	6	33	28.4	4 × 1	19.1	49.5	820
DIK 3210-6	32	10	33.75	26.4	3 × 1	25.7	52.2	600
DIK 3212-4	32	12	33.75	26.4	2 × 1	18.8	37	430
DIK 3610-6	36	10	37.75	30.5	3 × 1	28.8	63.8	710
DIK 3610-8	36	10	37.75	30.5	4 × 1	36.8	85	940
DIK 3610-10	36	10	37.75	30.5	5 × 1	44.6	106.3	1,160

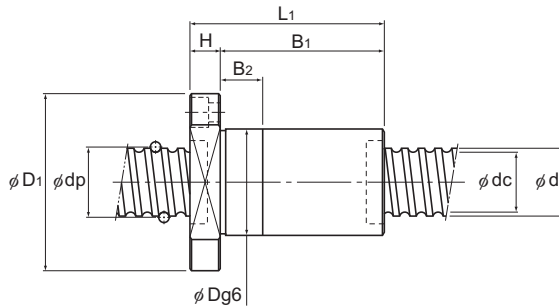

Unit: mm

	Nut dimensions										Screw shaft inertial moment/mm ²	Nut mass/kg	Shaft mass/kg/m	Permissible rotational speed/min ⁻¹
	Outer diameter/D	Flange diameter/D ₁	Overall length/L ₁	H	B ₁	B ₂	PCD	d ₁ ×d ₂ ×h	Tw	Lubrication hole/A				
	43	71	69	12	57	15	57	6.6×11×6.5	55	M6	4.74×10 ⁻⁷	0.61	4.27	2,430
	43	71	79	12	67	20	57	6.6×11×6.5	55	M6	4.74×10 ⁻⁷	0.68	4.27	2,430
	43	71	73	12	61	15	57	6.6×11×6.5	55	M6	4.74×10 ⁻⁷	0.64	4.36	2,410
	45	71	84	15	69	20	57	6.6×11×6.5	55	M6	4.74×10 ⁻⁷	0.82	4.18	2,390
	45	76	64	11	53	15	63	6.6×11×6.5	59	M6	8.08×10 ⁻⁷	0.57	5.86	2,150
	45	76	72	11	61	15	63	6.6×11×6.5	59	M6	8.08×10 ⁻⁷	0.62	5.86	2,150
	45	76	80	11	69	20	63	6.6×11×6.5	59	M6	8.08×10 ⁻⁷	0.66	5.86	2,150
	46	76	62	12	50	10	63	6.6×11×6.5	59	M6	8.08×10 ⁻⁷	0.6	5.67	2,130
	46	76	73	12	61	15	63	6.6×11×6.5	59	M6	8.08×10 ⁻⁷	0.67	5.67	2,130
	48	76	73	12	61	15	63	6.6×11×6.5	59	M6	8.08×10 ⁻⁷	0.74	6.31	2,120
	48	76	87	12	75	20	63	6.6×11×6.5	59	M6	8.08×10 ⁻⁷	0.85	6.31	2,120
	54	87	110	15	95	25	69	9×14×8.5	66	M6	8.08×10 ⁻⁷	1.57	4.98	2,070
	54	87	98	15	83	25	69	9×14×8.5	66	M6	8.08×10 ⁻⁷	1.43	5.2	2,070
	58	98	122	18	104	30	77	11×17.5×11	75	M6	1.29×10 ⁻⁶	2.03	6.51	1,850
	58	98	143	18	125	35	77	11×17.5×11	75	M6	1.29×10 ⁻⁶	2.3	6.51	1,850
	58	98	164	18	146	45	77	11×17.5×11	75	M6	1.29×10 ⁻⁶	2.57	6.51	1,850

Note: The overall length of the nut will increase when equipping the QZ Lubricator. See **■15-366** for further details.

DIK With Preload

DN value	70,000
----------	--------

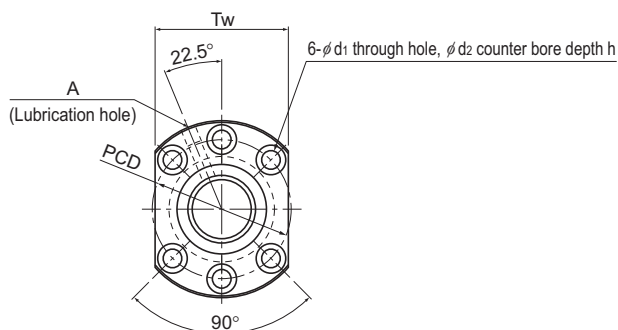

Model No.	Screw shaft outer diameter d	Lead Ph	Ball center-to-center diameter dp	Thread minor diameter dc	No. of loaded circuits Rows × turns	Basic load rating		Rigidity K N/μm
						Ca kN	C _{0a} kN	
DIK 4010-6	40	10	41.75	34.7	3 × 1	29.8	69.3	750
DIK 4010-8	40	10	41.75	34.7	4 × 1	38.1	92.4	1,000
DIK 4012-6	40	12	41.75	34.4	3 × 1	30.6	72.3	790
DIK 4012-8	40	12	41.75	34.4	4 × 1	39.2	96.4	1,030
DIK 4016-4	40	16	41.75	34.4	2 × 1	21.5	68.4	540
DIK 5010-6	50	10	51.75	44.4	3 × 1	33.9	90.7	940
DIK 5010-8	50	10	51.75	44.4	4 × 1	43.4	120.5	1,230
DIK 5010-10	50	10	51.75	44.4	5 × 1	52.5	150.9	1,530
DIK 5012-6	50	12	52.25	43.3	3 × 1	45.8	113	970
DIK 5012-8	50	12	52.25	43.3	4 × 1	58.6	150.6	1,270
DIK 5016-4	50	16	52.25	43.3	2 × 1	32.3	75.5	660
DIK 5016-6	50	16	52.25	43.3	3 × 1	45.7	113.3	970
DIK 6310-8	63	10	64.75	57.7	4 × 1	49.5	160.7	1,550
DIK 6312-6	63	12	65.25	56.3	3 × 1	51.9	147.4	1,200
DIK 6312-8	63	12	65.25	56.3	4 × 1	66.4	196.6	1,570

Positioning Ball Screw

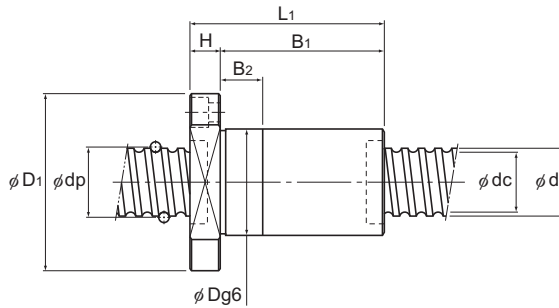

Unit: mm

	Nut dimensions										Screw shaft inertial moment/mm ²	Nut mass	Shaft mass	Permissible rotational speed
	Outer diameter	Flange diameter	Overall length							Lubrication hole				
	D	D ₁	L ₁	H	B ₁	B ₂	PCD	d ₁ ×d ₂ ×h	Tw	A				
	62	104	113	18	95	25	82	11×17.5×11	79	Rc1/8 (PT1/8)	1.97×10 ⁻⁶	2.09	8.22	1,670
	62	104	137	18	119	35	82	11×17.5×11	79		1.97×10 ⁻⁶	2.42	8.22	1,670
	62	104	138	18	120	35	82	11×17.5×11	79		1.97×10 ⁻⁶	2.44	8.5	1,670
	62	104	163	18	145	45	82	11×17.5×11	79		1.97×10 ⁻⁶	2.78	8.5	1,670
	62	104	120	18	102	30	82	11×17.5×11	79		1.97×10 ⁻⁶	2.19	8.83	1,670
	72	123	114	18	96	30	101	11×17.5×11	92		4.82×10 ⁻⁶	2.65	13.38	1,350
	72	123	137	18	119	35	101	11×17.5×11	92		4.82×10 ⁻⁶	3.03	13.38	1,350
	72	123	160	18	142	45	101	11×17.5×11	92		4.82×10 ⁻⁶	3.41	13.38	1,350
	75	129	145	22	123	35	105	14×20×13	98		4.82×10 ⁻⁶	3.83	12.74	1,330
	75	129	170	22	148	45	105	14×20×13	98		4.82×10 ⁻⁶	4.31	12.74	1,330
	75	129	129	22	107	30	105	14×20×13	98		4.82×10 ⁻⁶	3.52	13.41	1,330
	75	129	175	22	153	45	105	14×20×13	98		4.82×10 ⁻⁶	4.41	13.41	1,330
	85	146	141	22	119	35	122	14×20×13	110		1.21×10 ⁻⁵	4.16	21.93	1,080
	90	146	146	22	124	35	122	14×20×13	110		1.21×10 ⁻⁵	4.93	21.14	1,070
	90	146	171	22	149	45	122	14×20×13	110		1.21×10 ⁻⁵	5.56	21.14	1,070

Note: The overall length of the nut will increase when equipping the QZ Lubricator. See **■15-366** for further details.