

CNF No Preload

DN value	70,000
----------	--------

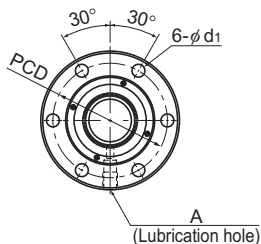

Model No.	Screw shaft outer diameter d	Lead Ph	Ball center-to-center diameter dp	Thread minor diameter dc	No. of loaded circuits Rows × turns	Basic load rating			Rigidity K	Nut dimensions				
						Ca	C _{0a}	N/μm		Outer diameter D	Flange diameter D ₁	Overall length L ₁	H	B ₁
						kN	kN			D	D ₁	L ₁		
CNF 1530-6	15	30	15.75	12.5	4×1.6	10.1	24.7	310	32	53	63	10	47	
CNF 2040-6	20	40	20.75	17.5	4×1.65	12	34.4	400	37	57	81	10	65	
CNF 2550-6	25	50	26	21.9	4×1.65	18.9	53.9	460	45	69	102	12	81.5	
CNF 3060-6	30	60	31.25	26.4	4×1.65	26.2	77.7	600	55	89	122	15	97	

Model number coding

CNF2040-6 ZZ +1500L C7 T H1K

Model No.

Contamination protection accessory symbol¹

Overall screw shaft length (in mm)

Accuracy symbol²

Symbol for rolled shaft

Recommended shaft ends shape code

¹ See **A15-356**. ² See **A15-12**.

Transport Ball Screw

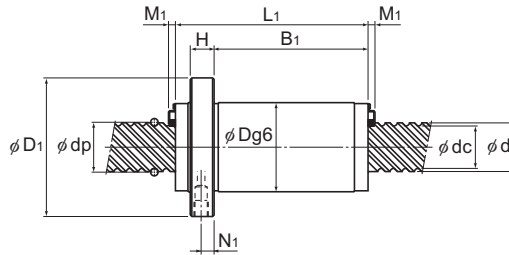

Unit: mm

	Nut dimensions					Axial clearance	Standard shaft length	Screw shaft inertial moment/ mm kg·m ² /mm	Nut mass kg	Shaft mass kg/m	Permissible rotational speed min ⁻¹
	PCD	d ₁	Lubrication hole		Seal M ₁						
			N ₁	A							
	43	5.5	5	M6	3.5	0.1	500, 1,000, 1,500	3.90×10^{-8}	0.42	1.19	4,440
	47	5.5	5.5	M6	3.5	0.1	500, 1,000, 1,500, 2,000	1.23×10^{-7}	0.5	2.12	3,370
	57	6.6	7	M6	3.5	0.1	1,000, 1,500, 2,000, 3,000	3.01×10^{-7}	0.85	3.34	2,690
	71	9	9	M6	3.8	0.14	1,000, 2,000, 3,000, 4,000	6.24×10^{-7}	1.7	4.84	2,240

Note: The overall length of the nut will increase when equipping the QZ Lubricator. See **A15-366** for further details.