

BLK (Precision Ball Screw) No Preload

DN value	70,000
----------	--------

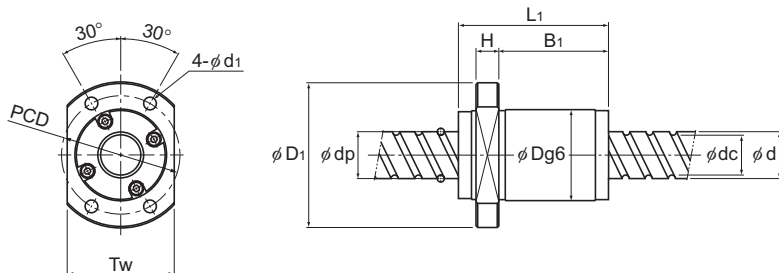

BLK0808

Model No.	Screw shaft outer diameter d	Lead Ph	Ball center-to-center diameter dp	Thread minor diameter dc	No. of loaded circuits Rows X turns	Basic load rating		Rigidity K N/μm
						Ca kN	C _{0a} kN	
BLK 0808-3.2	8	8	8.4	6.7	2×1.6	2.2	3.8	95
BLK 1510-5.6	15	10	15.75	12.5	2×2.8	14.3	27.8	340
BLK 1616-2.8	16	16	16.65	13.7	1×2.8	5.2	9.9	180
BLK 1616-3.6	16	16	16.65	13.7	2×1.8	7.1	14.3	220
BLK 2020-2.8	20	20	20.75	17.5	1×2.8	8.1	17.2	230
BLK 2020-3.6	20	20	20.75	17.5	2×1.8	11.1	24.7	290
BLK 2525-2.8	25	25	26	21.9	1×2.8	12.2	26.9	270
BLK 2525-3.6	25	25	26	21.9	2×1.8	16.6	38.7	350
BLK 3232-2.8	32	32	33.25	28.3	1×2.8	17.3	41.4	340
BLK 3232-3.6	32	32	33.25	28.3	2×1.8	23.7	59.5	440
BLK 3620-5.6	36	20	37.75	31.2	2×2.8	54.9	134.3	760
BLK 3624-5.6	36	24	38	30.7	2×2.8	63.8	151.9	770
BLK 3636-2.8	36	36	37.4	31.7	1×2.8	22.4	54.1	390
BLK 3636-3.6	36	36	37.4	31.7	2×1.8	30.8	78	490
BLK 4040-2.8	40	40	41.75	35.2	1×2.8	28.2	68.9	430
BLK 4040-3.6	40	40	41.75	35.2	2×1.8	38.7	99.2	550
BLK 5050-2.8	50	50	52.2	44.1	1×2.8	42.2	107.8	530
BLK 5050-3.6	50	50	52.2	44.1	2×1.8	57.8	155	670

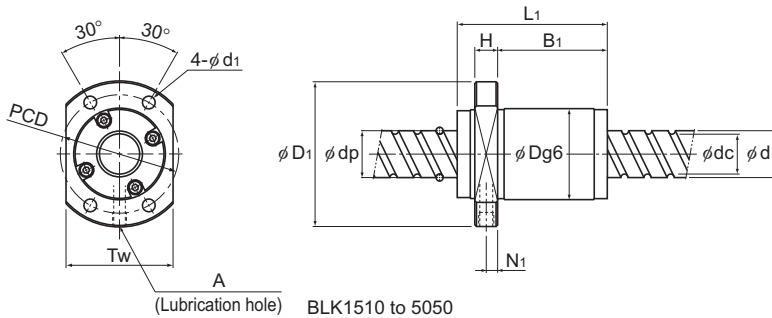

Unit: mm

	Nut dimensions										Screw shaft inertial moment/mm ³ kg·m ² /mm	Nut mass kg	Shaft mass kg/m	Permissible rotational speed min ⁻¹
	Outer diameter D	Flange diameter D ₁	Overall length L ₁	H	B ₁	PCD	d ₁	Tw	N ₁	Lubrication hole A				
	18	31	20	4	10	25	3.4	20	—	—	3.16 × 10 ⁻⁹	0.03	0.36	3,500
	34	57	44	10	24	45	5.5	40	5	M6	3.9 × 10 ⁻⁸	0.34	0.31	4,440
	32	53	54	10	37.5	42	4.5	38	5	M6	5.05 × 10 ⁻⁸	0.32	1.41	4,200
	32	53	38	10	21.5	42	4.5	38	5	M6	5.05 × 10 ⁻⁸	0.21	1.41	4,200
	39	62	65	10	47.5	50	5.5	46	5	M6	1.23 × 10 ⁻⁷	0.49	2.25	3,370
	39	62	45	10	27.5	50	5.5	46	5	M6	1.23 × 10 ⁻⁷	0.35	2.25	3,370
	47	74	80	12	60	60	6.6	56	6	M6	3.01 × 10 ⁻⁷	0.89	3.52	2,690
	47	74	55	12	35	60	6.6	56	6	M6	3.01 × 10 ⁻⁷	0.64	3.52	2,690
	58	92	102	15	77	74	9	68	7.5	M6	8.08 × 10 ⁻⁷	1.78	5.83	2,100
	58	92	70	15	45	74	9	68	7.5	M6	8.08 × 10 ⁻⁷	1.32	5.83	2,100
	70	110	78	17	45	90	11	80	8.5	M6	1.29 × 10 ⁻⁶	2.23	6.49	1,850
	75	115	94	18	59	94	11	86	9	M6	1.29 × 10 ⁻⁶	3.05	6.39	1,840
	66	106	113	17	86	85	11	76	8.5	M6	1.29 × 10 ⁻⁶	2.61	7.34	1,870
	66	106	77	17	50	85	11	76	8.5	M6	1.29 × 10 ⁻⁶	1.93	7.34	1,870
	73	114	125	17	96.5	93	11	84	8.5	M6	1.97 × 10 ⁻⁶	3.4	9.01	1,670
	73	114	85	17	56.5	93	11	84	8.5	M6	1.97 × 10 ⁻⁶	2.48	9.01	1,670
	90	135	156	20	122	112	14	104	10	M6	4.82 × 10 ⁻⁶	6.18	14.08	1,340
	90	135	106	20	72	112	14	104	10	M6	4.82 × 10 ⁻⁶	4.45	14.08	1,340

Notes: The Model BLK can be equipped with a brush seal depending on the model number. Contact THK if you would like to use one.

The overall length of the nut will increase when equipping the QZ Lubricator. See **A15-366** for further details.